



Features

- ✓ Highly effective delivery of medicine
- ✓ Short-inhalation
- ✓ Fine particle size
- ✓ Approved medical device
- ✓ Compressed-air technology
- ✓ Powerful-high nebulisation rate



Specifications

Model	NB-222C
Rated voltage	AC 230V, 50Hz
Extreme pressure	>210KPa
Free flow range	>7L/min
Nebulising pressure	60~180Kpa
Noise level & rated power	≤ 65dB, ≤ 200VA
Max capacity of nebuliser kit	10ml
Particle size & nebulising rate	≤5 μm & 60% and ≥0.2ml/min
Operation mode	20 minutes on, 40 minutes off
Operation temperature and humidity atmospheric pressure	10°C ~ 40°C, 85% and below, 860~1060hPa
Transport and storage temperature and humidity/atmospheric pressure	-10°C ~ 40°C, 95% and below, 500~1060hPa
Size	140mm x 140mm x 100mm
Pollution degrees	Degrees 2
Overvoltage category	Category II
High altitudes (m)	2000m
Accessories	Nebuliser kit, inhalation mouthpiece, inhalation tube

Structure

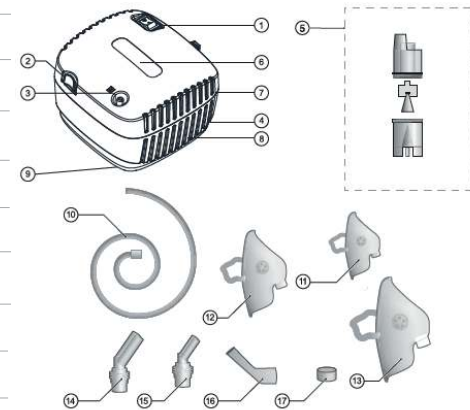

- | | |
|-------------------------|----------------------------------|
| 1. Power switch | 10. Inhalation Tube |
| 2. Holder for Nebuliser | 11. InfantMask(Optional) |
| 3. Air plug | 12. Child Mask(Optional) |
| 4. Dust Screen Cover | 13. Adult Mask(Optional) |
| 5. Nebuliser Kit | 14. Adult Nasal-piece(Optional) |
| 6. Logo | 15. Child Nasal-pieces(Optional) |
| 7. Main Unit | 16. Inhalation Mouthpiece |
| 8. thermal Via | 17. Air Filter |
| 9. Rubber Foot | |

The nebuliser kit, and mask, nasal-piece, mouthpiece are applied parts